

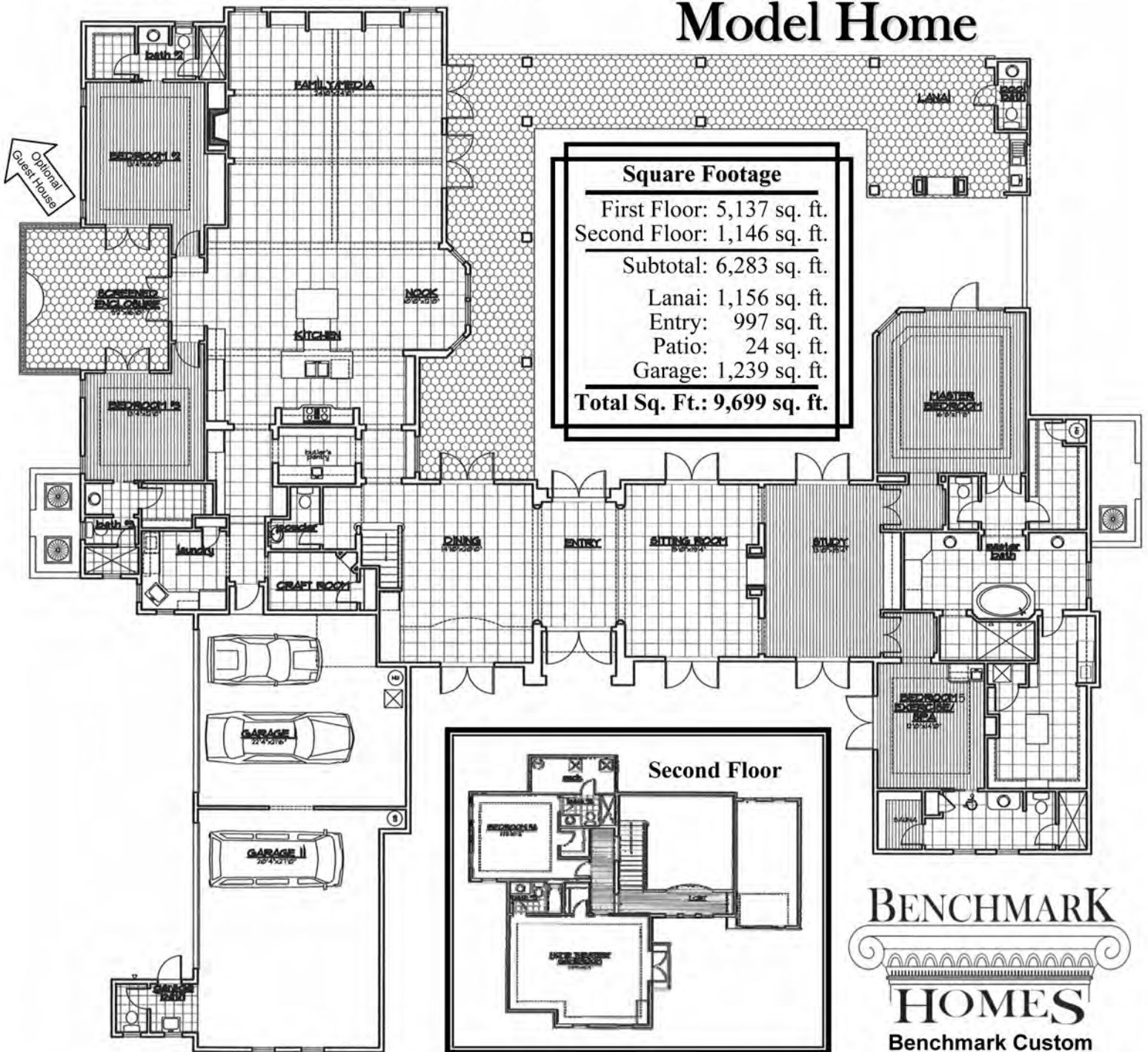

Benchmark Homes presents...

# The Found Forest Model Home



**BENCHMARK**  
**HOMES**  
 Benchmark Custom  
 Luxury Homes

# Found Forest Model Home Features



904.280.8777

[www.customluxuryhomes.com](http://www.customluxuryhomes.com)

## General Features:

- 4 or 5 Bedrooms
- 6 Full baths and 3 half baths
- Fitness center with steam and sauna
- Game room with 58" plasma television and Juliet balcony
- Loft library with rolling library ladder and stained glass windows
- Black-glazed maple wood study with wood mantel and granite and glass tile floors
- Three Isokern fireplaces with custom designed surrounds
- Audio/visual package including 65" high definition, 1080i plasma television and surround sound, with 10 pairs of speakers throughout the home

## Interior Features:

- Unique wall finishes including stucco, Venetian plaster and various faux painting techniques
- Custom ceiling beams with antique corbels
- Antique interior doors
- Antique columns in foyer
- European oak hardwood floors on first floor
- Stone floors on second floor
- Copper sinks and tub in master bath
- Stone and copper sinks throughout home
- Unique stone, onyx and copper counter tops
- Designer lighting package with Lutron system
- Custom cabinetry throughout home

**Priced at \$2,995,000**  
**Includes full Club membership**  
**40' boat slip available at**  
**market price**

## Appliances:

- Professional Series Viking appliances, including a 48" gas free-standing range, 36" built-in bottom mount refrigerator/freezer, two undercounter wine refrigerators, electric convection oven, convection microwave oven and warming drawer
- Fisher & Paykel dish drawers
- Food pantry with 30" refrigerator & freezer
- Samsung undercounter washer/dryer in laundry room
- Asko undercounter washer/dryer in her closet
- Undercounter refrigerators in fitness center and game room

## Exterior Features:

- Concrete steel-form "Safewall" construction
- Hurd impact glass windows and doors
- Artistic stucco with solid, hand crafted bands and columns
- Concrete tile roof
- 16KW generator system
- Tankless water heaters (4)
- Four-car garage with workshop
- Screened morning garden with access from kitchen and two bedrooms
- Screened 1,000+ sq. ft. Mexican stone courtyard with Viking grill and hood, glass tile water sculpture pond, glass tile and river rock jacuzzi, and pool with glass water-line tile and pebblecrete finish
- Pool bath with glass tile top, stone sink and faux painted walls
- Concrete paver driveway at guest entrance courtyard and owners' entrance courtyard
- Entire structure meets or exceeds stringent new Florida Uniform Building Codes & Southern Building Codes
- Structure engineered by licensed structural engineer to meet or exceed the latest hurricane codes
- Termite pre-treatment with \$1,000,000 re-treatment coverage and damage repair coverage
- Optional Guest House – Design available upon request

## The Benchmark Pledge

Each individual element of your home will be a showcase of creativity, craftsmanship and attention to detail and quality...

***You have our promise!***